

Hotmarker SP Series

# Cutter arm error Recovery method

If the cutter cam is engaged and becomes inoperable, follow the steps below.



- Be sure to turn the "main power switch" to "OFF" and unplug the "power cord" from the outlet. Failure to do so may result in injury from malfunction.
- The tip of the cutter blade is very sharp. Please be careful not to cut your fingers.

1. Turn the cutter depth adjustment knob about 5 turns to the left (to make the depth shallower).
2. Remove the main cover of the Hotmarker body by removing the two M3 binding screws on the top and rotating the cover backward. (Refer to Instruction Manual II)
3. Remove the cutter unit cover.

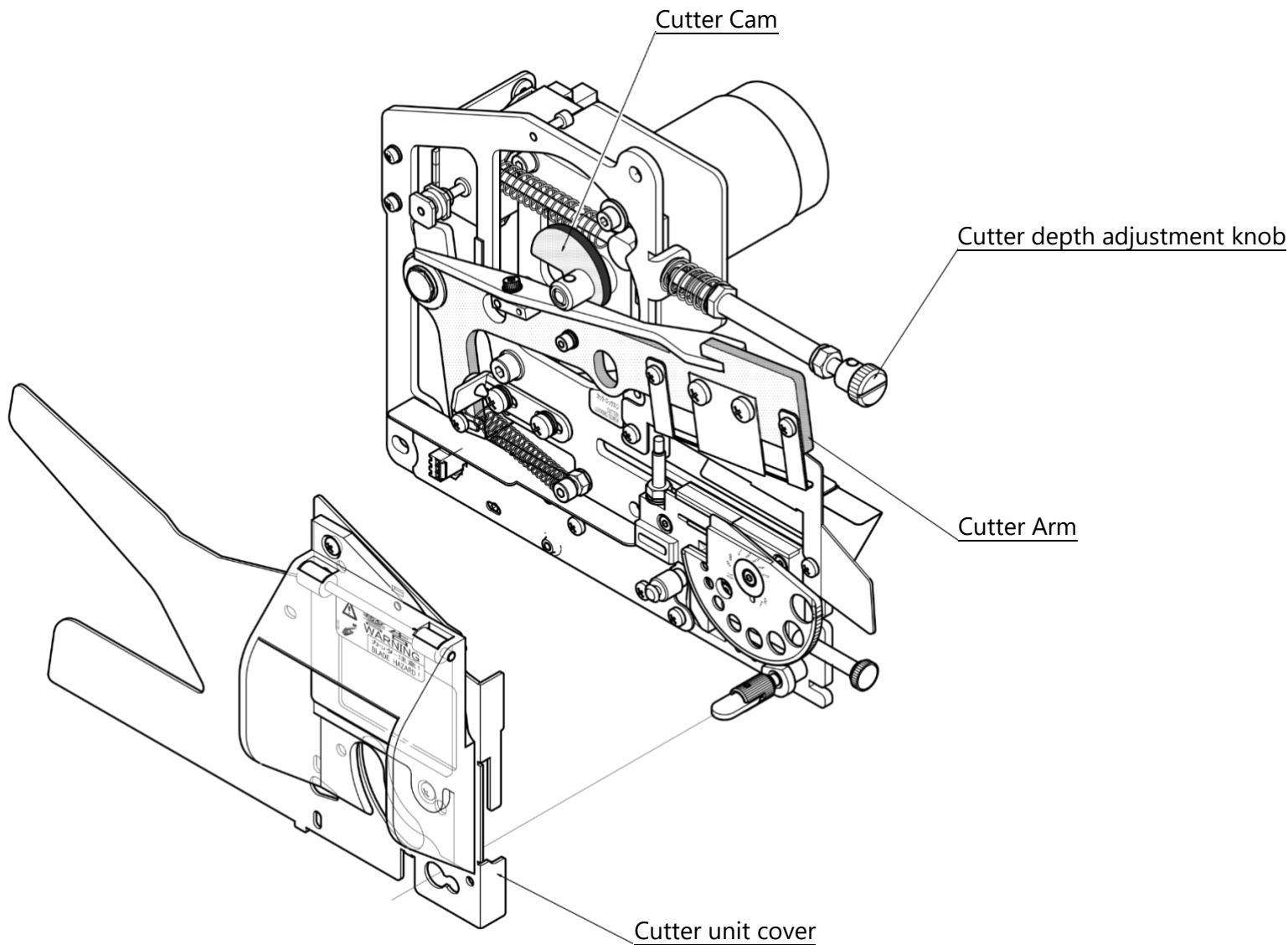

4. Push in the lower part of the cutter cam with a thin flat-blade screwdriver and rotate the cam.

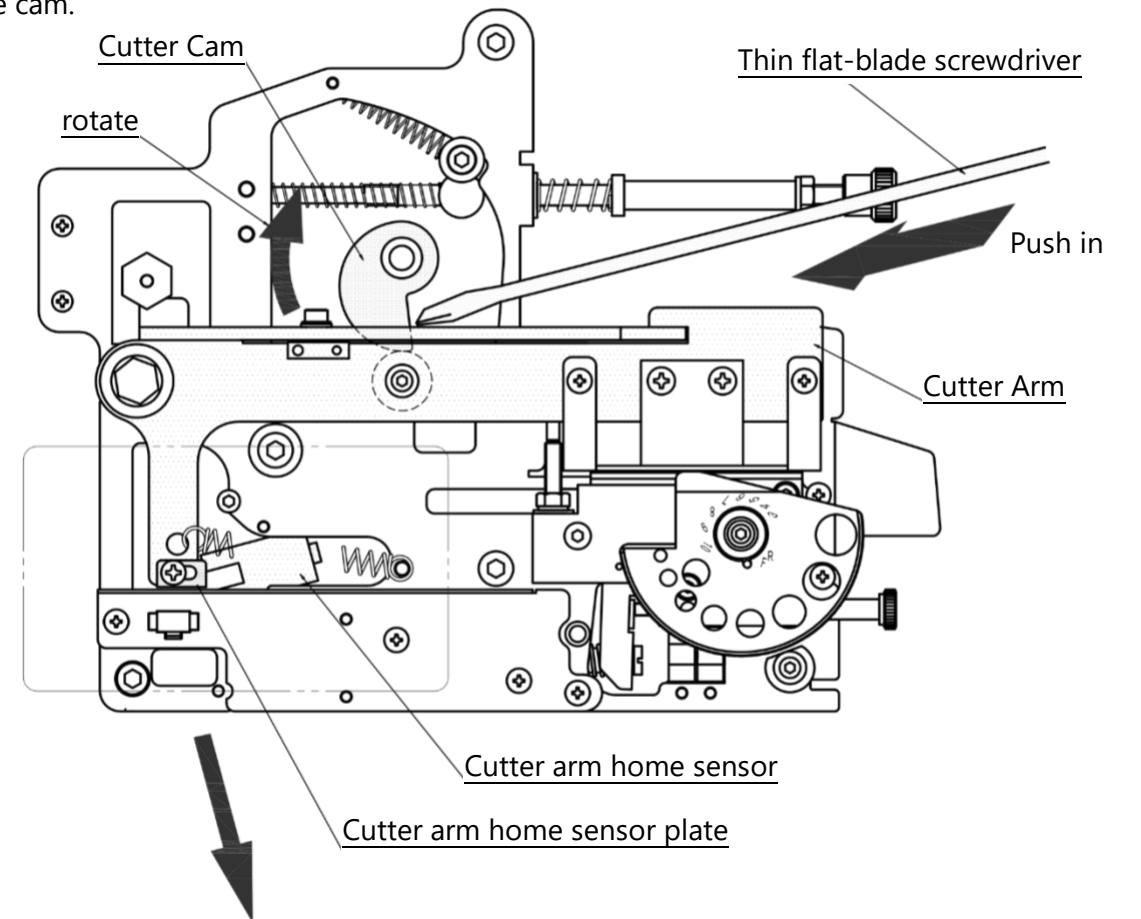

5. Make sure that the cutter arm is lifted and the cutter arm home sensor responds normally.

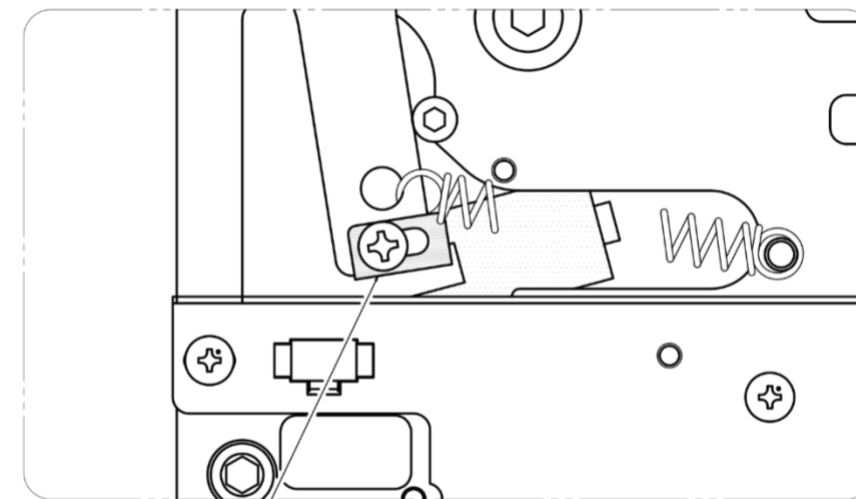

Make sure that the sensor plate goes through the sensor properly  
(If the sensor plate is detected, the pilot lamp is turned on.)